

# **CAMPLEX**<sup>®</sup>

## **BROADCAST FIBER OPTIC SOLUTIONS**

### **USER MANUAL**

#### **Complex CMX-HDMI-SFP HDMI over Fiber SFP Extender SFP-Based Transmission System**



#### **FEATURES**

- Transmission Up to 3300 Feet over Single Mode
- Single Fiber Simplex Operation
- Video Resolutions up to 4K2K@50/60Hz
- Bi-directional Infrared Control
- RS-232 Transmission
- Locking Power Adapters
- CE, RoHS Certified

#### **INCLUDES**

Two 5VDC/2A Power Supplies  
Two SFP Modules  
Two Pair IR Blasters  
Two RS232 Connectors

## CMX-HDMI-SFP TRANSMITTER

### Front



- 1 System Power LED Indicator
- 2 Optical Link LED Indicator
- 3 HDMI Input Signal LED Indicator

### Rear

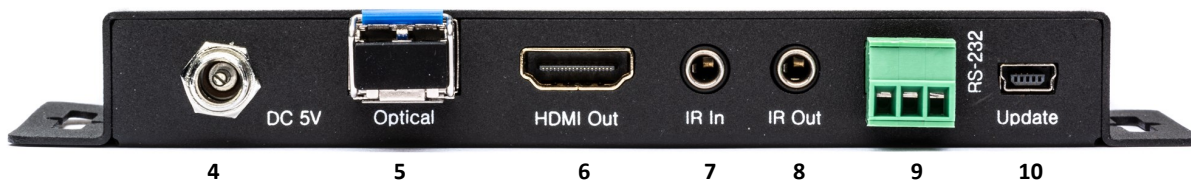

- 4 Connect Power Supply
- 5 Optical—SFP Port
- 6 Connect to HDMI Source
- 7 Connect IR Receiver Cable. Place IR Receiver Header Close to Display Device's IR Receiver
- 8 Connect IR Emitter Cable. Place IR Emitter Header Close to Source Device's IR Receiver
- 9 RS-232
- 10 Factory Use Only

## CMX-HDMI-SFP RECEIVER

### Front



- 1 System Power LED Indicator
- 2 Optical Link LED Indicator
- 3 HDMI Input Signal LED Indicator

### Rear

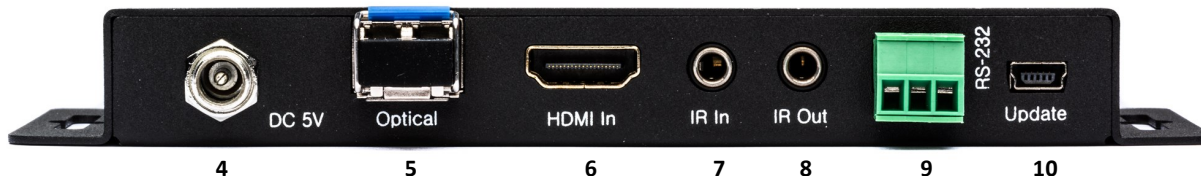

- 4 Connect Power Supply
- 5 Optical - SFP Port
- 6 Connect to HDMI Display
- 7 Connect IR Receiver Cable. Place IR Receiver Header Close to Display Device's IR Receiver
- 8 Connect IR Emitter Cable. Place IR Emitter Header Close to Source Device's IR Receiver
- 9 RS-232
- 10 Factory Use Only

## CONNECTION DIAGRAM

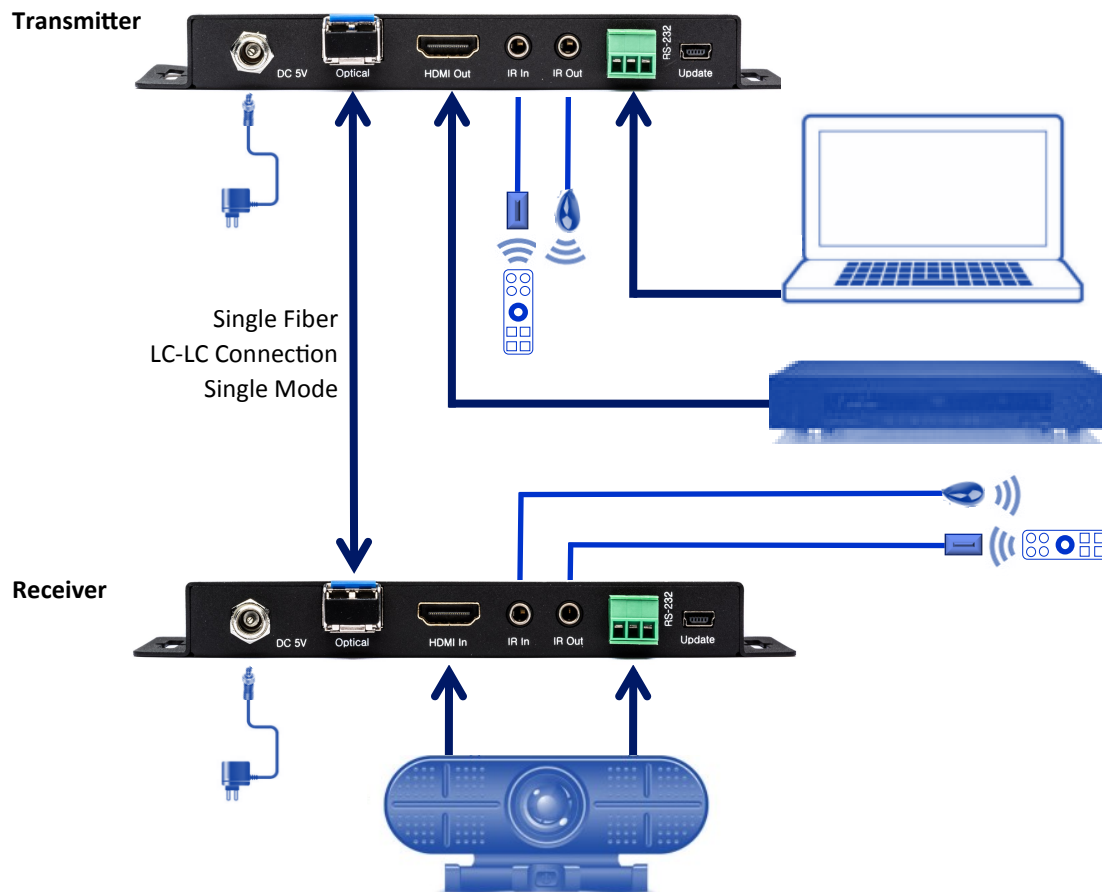

## SPECIFICATIONS

Compliance	HDMI 2.0b (18Gbps), HDCP 2.2, DVI
Video Bandwidth	18Gbps
Video Resolutions	4K2K@50/60Hz(YUV4:4:4) 4K2K@30Hz 1080P@120Hz 1080P 3D@60Hz
Color Space	RGB, YCbCr 4:4:4, YCbCr 4:2:2
Color Depth	8-bit, 10-bit, 12-bit
HDMI Audio Formats	LPCM 2/5.1/7.1CH Dolby Digital DTS 5.1 Dolby Digital+ Dolby TrueHD DTS-HD Master Audio Dolby Atmos DTS:X

Transmission Distance	Single Mode: 3300 feet/1000 meters Multimode (OM3): 1000 feet/300 meters
IR Frequency	20KHz-60KHz
RS-232 Baud Rate	4800-115200bps
Power Consumption	3W
Power Input	AC100 - 240V 50/60Hz
Dimensions Each Unit	6.375 (w/mounting ears) x 2.7 x 0.75in / 162 x 68.58 x 19.05mm
Weight	TX: 9.03 oz/256g, RX: 9.17 oz/260g

# **CAMPLEX<sup>®</sup>**

## **BROADCAST FIBER OPTIC SOLUTIONS**

### **SAFETY PRECAUTIONS**

1. To prevent fire or shock hazard, do not expose this equipment to high humidity and/or dust. Do not use in an unprotected outdoor installation nor any area classified as overly damp or wet.
2. The temperature for installation should be between 32°F to 140°F (0°C to 60°C). Avoid direct sunlight exposure or extreme changes of temperature over a short period of time.
3. Do not disassemble the unit or place it on an unstable base.
4. Do not drop the unit and avoid heavy impact.
5. This unit should not be placed in a built-in installation unless proper ventilation is provided. Any openings in the enclosure must not be blocked or covered as they protect the unit from overheating.
6. Before cleaning, unplug the unit from all connections. Use a clean, slightly damp cloth. Do not use liquid or aerosol cleaners. Use appropriate cleaning kits for fiber optic cables.
7. Do not overload outlets and extension cords as this could result in a fire or electric shock.
8. Enclosure entry is dangerous. Never push objects of any kind, including liquids, into this unit through openings as they may touch dangerous voltage points or short-out parts that could result in a fire or electric shock.
9. Do not attempt to open or service this unit yourself as opening or removing covers may expose you to dangerous voltage and other hazards.
10. There are no user-serviceable parts inside the unit. If the unit requires service contact your authorized dealer, or an authorized repair service company.